



Snowflake instructions:



1. Materials:
2 bottle caps (1 color & 1 white)
1 wire stick
1 lid top
1 cup (precut snowflake)



2. Bend wire in half and "thread" through two holes in colored bottle cap.



3. Pinch wire and "thread" both ends through hole in lid.



4. Next, "thread" wire through hole in cup center on white side. Print will be on back.



5. Secure layers by twisting wire tightly around bottle cap at back. *Note: In order for snowflake to lie flat, all pre-cut "arms" must be cut to the base of cup.

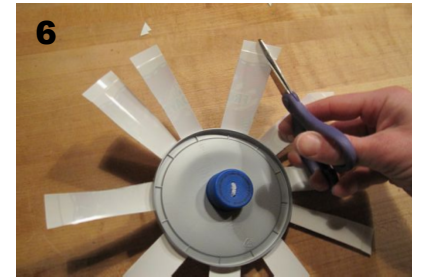

6. Finally, cut arms into patterns to create your unique, one of a kind snowflake. Use hole puncher for added details and to secure string for hanging.



*Happy Holidays from
Peace, Love & Planet!*

